



DB Stable

Happy
Ending :)



DB Stable

China Portable Horse Stable
Factory.
Mainly export to Australia
and New Zealand.

DB Stable
Portable
Horse Stable
Factory

Contact Us

☎ : +83 15324294271
☎ : +86 15324294271

✉ : info@dbstable.com
🌐 : www.dbstable.com

📍 : No.6 HuaFuXiJie, Anping,
China

DB Stable® mainly manufactures high quality portable horse stables, exporting to Australia and New Zealand Since 2013.

COMPANY PROFILE

Since 2013, DB Stable has developed “Portable Horse Stables” from the single fencing factory.

In order to entry the livestock and farm market in Australia and New Zealand, considering our mature welding process, high quality products, and better prices, we began to provide the “Portable Horse Stables” with its relevant products.

Safety

Portable Horse Stable surface-treated well in order to no hurt to horses

Instant Response

Reply Within 6 hours after receiving your Inquiry



MISSION

Develop the best quality portable horse stables at an affordable price, meet all your farming and livestock needs and requirements.

1. What can you buy from us?

Horse Stables, Horse Panels, Horse Feeder with other relevant products.

2. Why should you buy from us not from other suppliers?

We are manufacture with our own factory. Producing high quality and low price are our advantages.



Bulk Shipping

Bulk goods are transported by the sea at a low cost usually

Recyclable

Our materials are eco-friendly and biodegradable.

ADVANTAGES

After studying the horse equipment market in Australia and New Zealand, we supply the different sizes and breeds suit for the different area and events. Because of its labour concentrated industry in China, we can do our best to supply the same level quality of horse stall, but the much better prices, compared with Australia local horse stable with its fittings.

Quick Shipping

If hurry, we can also send it to you by air at an extra cost.



SALES MANAGER OF DB STABLE

Frank Zhang

Being an experienced horse rider, The sales manager Frank Zhang has a lot of knowledge that how to keep horse safe, how to train well, or others. Also, he has been to visited so many horse owner, trainers, and clubs of Australia, there are so many local suggestions value to learn. Many years passed, we have grown up into one of the modern horse barn company about production, quality control, sales and export.



PRODUCTS

The biggest advantage of our portable horse stable is that they are beautiful and cost-effective.

We are in the wholesale business, because the value of the goods is low, so it is easy for customers to make purchase decisions after seeing the products on the web-site.

All Portable Horse Stable Products

High Quality Win The Customer

High Quality With Lowest Price

OEM Available

We support any form of
OEM customization
requirements



WHY CHOOSE DB STABLE

According to our insightful investigation, we discover that most of portable horse stable in Australia and NZ are from Shandong, Fujian, Zhejiang in China. As everyone knows, Anping is the hometown of wire mesh, so we have the great advantages of material cost, intensive production, quality control, and shipping.

Global Support

Contact us 24×7 to
solve all your af-
ter-sales problems.

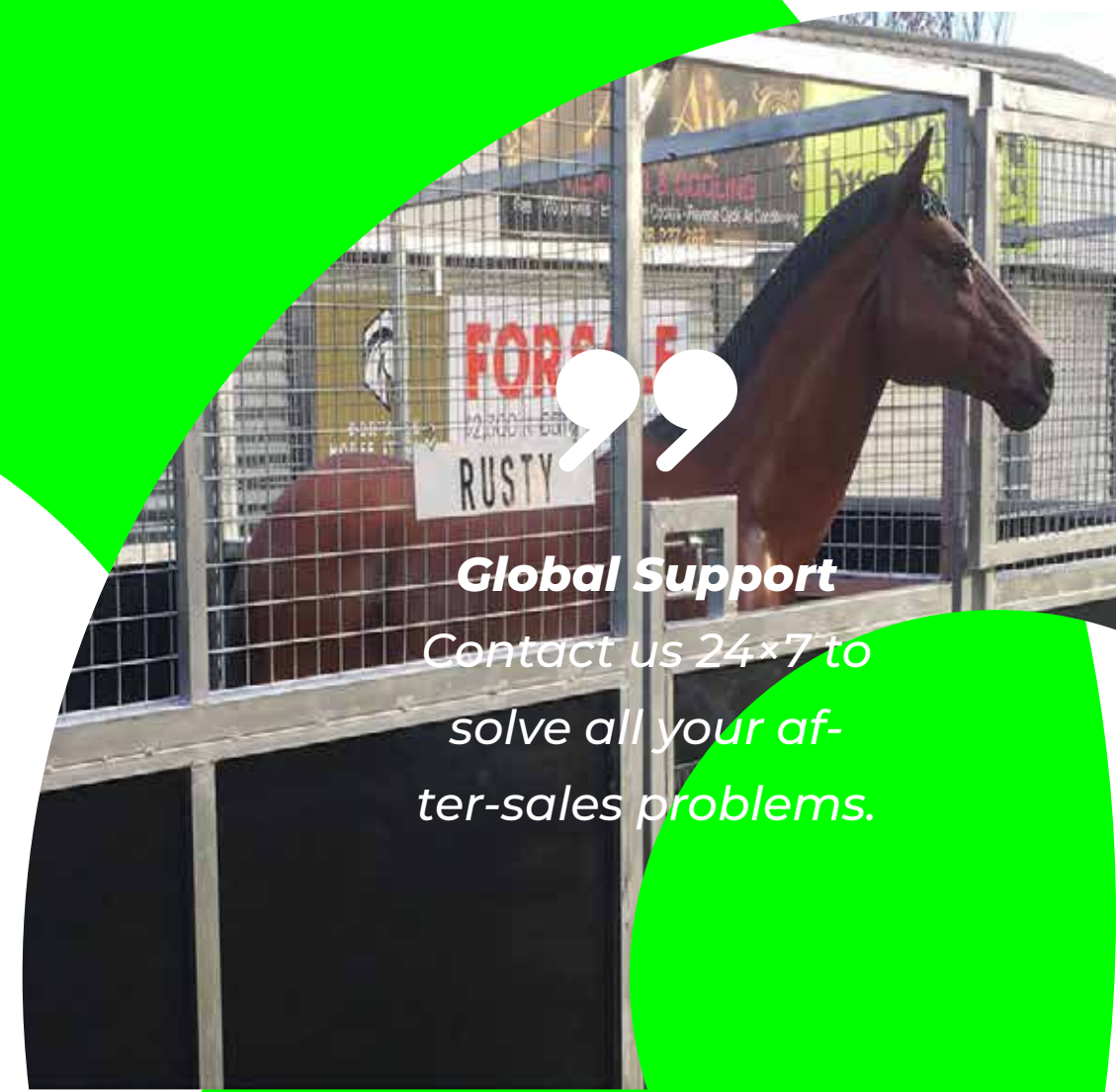

PIPE UPPER PORTABLE HORSE STABLE

Our Pipe Upper Portable Horse Stable includes galvanised RHS frame, upper round pipe welded on the frame tube up and down, HDPE board fixed on the down frame, even the top colorbond roofs, swing/sliding gate for the front stable panel. Pipe dividing stable wall has the same structures.



Product Name: Pipe Upper Portable Horse Stable

Size: 3.6m x 3.6m x 2.2m Height, or 4.2m x 4.2m x 2.2m Height (If with foofs, the max height is 2.9m at front and 2.2m at rear)

Gate: swing or sliding gate

Metal Frame: Hot dipped galvanised 50x50mm square tube, galvanising over 42um

Infilled upper round pipe: HDG 20 x 1.2mm

HDPE Board: 10mm thick infill making stall durable, UV resistant

Roof: 0.4-0.8mm thick, power coated blue or grey color to resist rain and sun

Swivel Feeder: Aluminium material



PROCESS

Steel tubes cutting – welding panels – polishing the welding points – anti rust painting – silver spray painting – fix HDPE plate to stable panel and gate

Prefabricated Barns Features—Represent Quality, Flexibility, Durability, Security And Portability

Open 180 degrees swing gate 1350mm width with simple latches including

Bottom pin to stop gate out

Durable framework flatting for effective transport, such as load and unload by fork-lift.

Heavy duty panels need 4-5 people to erect

Simple strong Plug-In corner pin for fast easy fixing panels

Share the same back or side panels if stables together

Integrate a day yard with horse panels together.

Rounded edges to prevent injury

Unique foot lock design to be more solid

Adjustable, strong hinges with rounded tabs to prevent injury

Be quickly and easily erected inside of sheds or out in the paddock. No need to dig holes or lay the foundation.

Last long with its galvanised frame anti-corrosion and 10mm thick HDPE board uvioresistant

Colorbond roofs or shelters to anti-rain and sunshine

10 Years quality guarantee

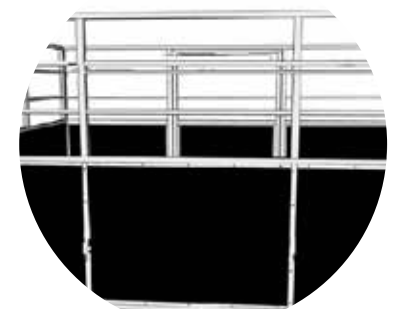

Different Upper Mesh Portable Horse Stable

In order to make the horse much robust, training is one thing, the portable horse stable is set up to make the purebred horse much comfortable and restful.

Product Name: Upper Mesh Portable Horse Stables
Size: 3.6m x 3.6m x 2.2m, 4.0m x 4.0m x 2.2m, 5.0m x 5.0m x 2.2m
Gate: 1.3m width swing or sliding gate
Metal Frame: Hot dipped galvanised 50 x 50mm square tube, galvanising over 42um
Infilled Upper Mesh Panel: HDG 5.0x50x50mm
HDPE Board: 10mm thick infill making stall durable, UV resistant
Roof: 0.4-0.8mm thick, power coated blue or grey color to resist rain and sun

The Process

Steel tubes cutting – welding panels – polishing the welding points – anti rust painting – silver spray painting – fix HDPE plate to stable panel and gate

Different Outdoor Stable Types and Sizes Suit For Various of Applications

*Internal Portable Horse Stable
Centre Aisle Barn In Sheds
Outdoor Portable Horse Stable
Back-to-Back Portable Horse Stables*



Upper Mesh Portable Horse Stable

is the most economic building for horses, which is durable and last long. Why not choose a quality home for horses.

Product Name: Upper Mesh Portable Horse Stable
Size: 2.95m x 2.95m x 2.2m Height, 3.6m x 3.6m x 2.2m Height, or 4.2m x 4.2m x 2.2m Height (If with roofs, the max height is 2.9m at front and 2.5m at rear)
Gate: 1.3m width swing or sliding gate
Metal Frame: Hot dipped galvanised 50 x 50mm square tube, galvanising over 42um
Infilled Upper Mesh Panel: HDG 5.0x50x50mm
HDPE Board: 10mm thick infill making stall durable, UV resistant
Roof: 0.4-0.8mm thick, power coated blue or grey color to resist rain and sun

Process

Steel tubes cutting – welding panels – polishing the welding points – anti rust painting – silver spray painting – fix HDPE plate to stable panel and gate.



Full HDPE Portable Horse Stable

10 Conjoined Back-To-Back Portable Stables With Roof And Splint

Our 10 Conjoined Back-To-Back Portable Stables With Roof And Splint includes 20 front sides panels with gates + 10 back sides + 4 outside right/left panels + 18 Inner side panels+ grey roofs.

Size: 36m x 7.2m x 2.2m Height, or 42m x 8.4m x 2.2m Height
(If with roofs, the max height is 2.9m at front and 2.5m at rear).

Metal Frame: Hot dipped galvanised 50x50mm square tube, galvanising over 42um

Infilled upper round gate pipe: HDG 20 x 1.2mm

HDPE Board: 10mm thick infill making stall durable, UV resistant

Roof: 0.4-0.8mm thick, power coated blue or grey color to resist rain and sun

Galvanised Splint: Arc design, fixed HDPE board and frame, will not hurt the horse, and solve the HDPE board heat deformation of the important problem

Sudoku Panel Design: Greatly reduced the degree of convex deformation of the HDPE board after the hot sunlight

Connect way Pin: HDG finishes 40x40mm square metal tube

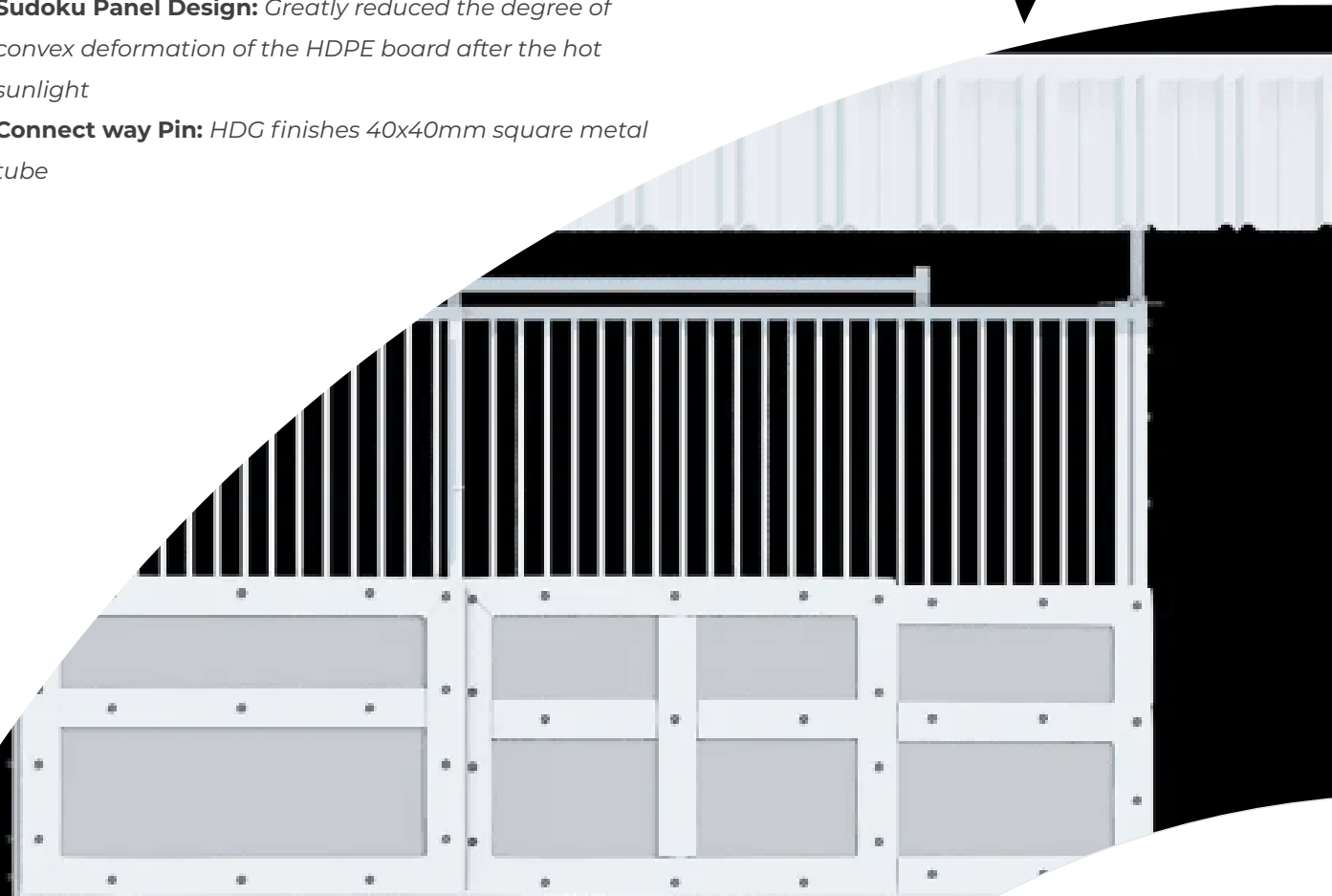
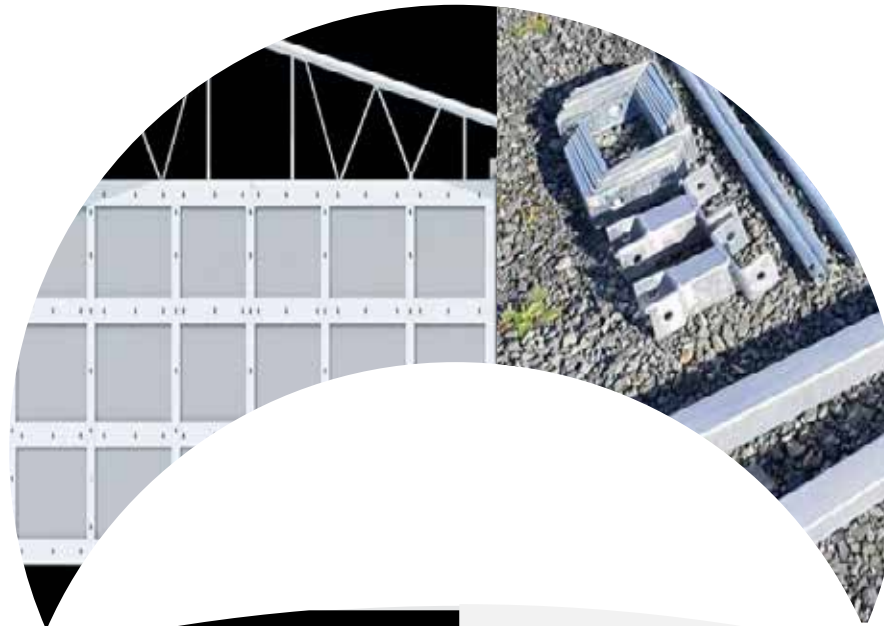

5 Conjoined Back-To-Back Portable Stables With Roof And Splint

Size: 18m x 7.2m x 2.2m Height, or 21m x 8.4m x 2.2m Height (If with roofs, the max height is 2.9m at front and 2.5m at rear).

Metal Frame: Hot dipped galvanised 50x50mm square tube, galvanising over 42um

Infilled upper round gate pipe: HDG 20 x 1.2mm

HDPE Board: 10mm thick infill making stall durable, UV resistant

Roof: 0.4-0.8mm thick, power coated blue or grey color to resist rain and sun

Galvanised Splint: Arc design, fixed HDPE board and frame, will not hurt the horse, and solve the HDPE board heat deformation of the important problem

Sudoku Panel Design: Greatly reduced the degree of convex deformation of the HDPE board after the hot sunlight

Connect way Pin: HDG finishes 40x40mm square metal tube

Process

Steel tubes cutting – welding
panels – polishing the welding
points – anti rust painting – silver
spray painting – fix HDPE plate to
stable panel and gate

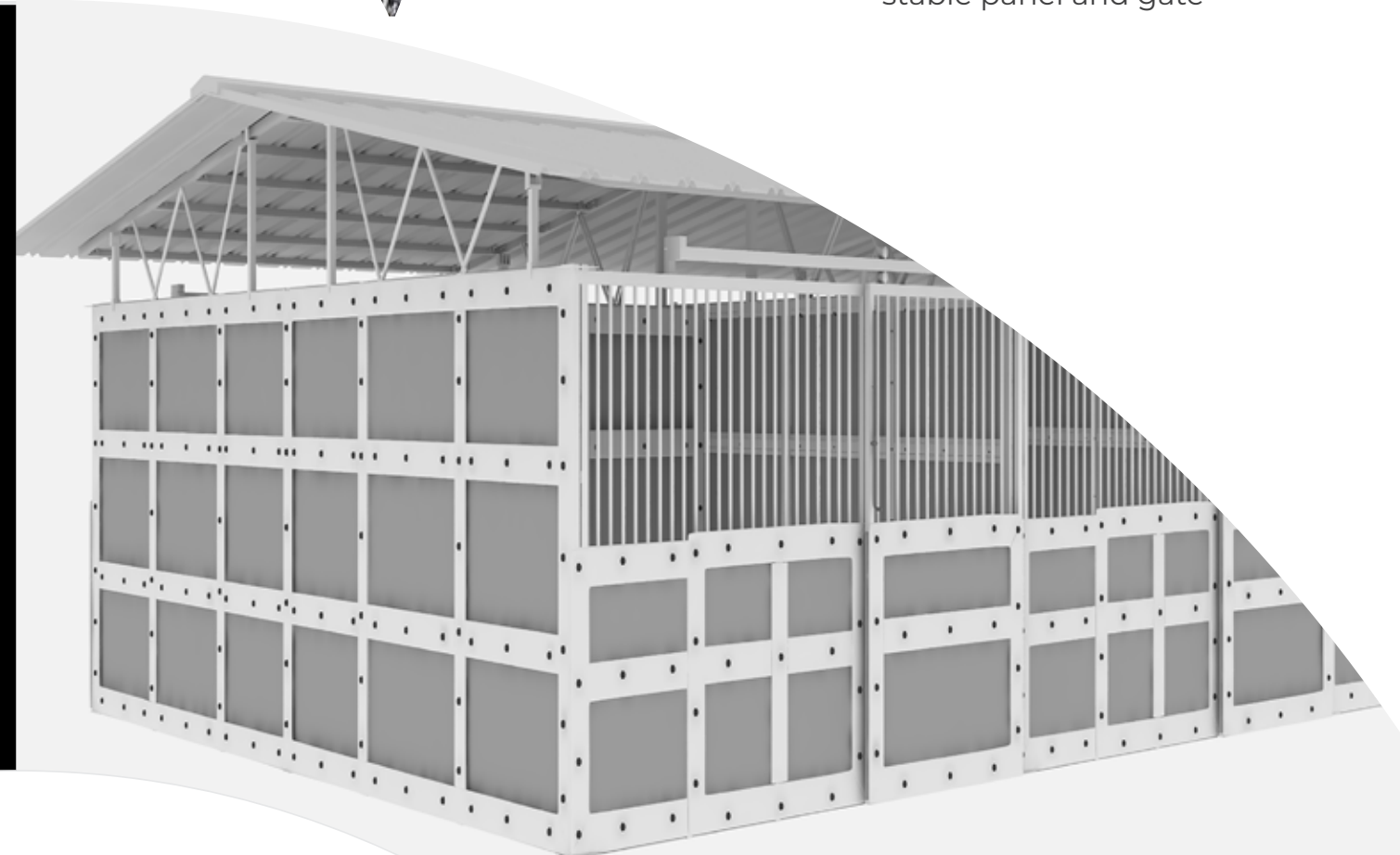

Full Colorbond Toolhouse

The Full colorbond toolhouse is designed to create fully enclosed colorbond. It is usually used as side and back panels to isolate with others and to be a forage room or tool-house.

Size: 6m x 2.2m Height, or 4.2m x 2.2m Height

Metal Frame: Hot dipped galvanised 50x50mm square tube, galvanising over 42um

Colorbond: 0.4-0.8mm wall thick powder coated grey color

HDPE Board: 10mm thick infill making stall durable, UV resistant

Bolts and Nuts: HDG or SS304 Material

Connect way Pin: HDG finishes 40x40mm square metal tube

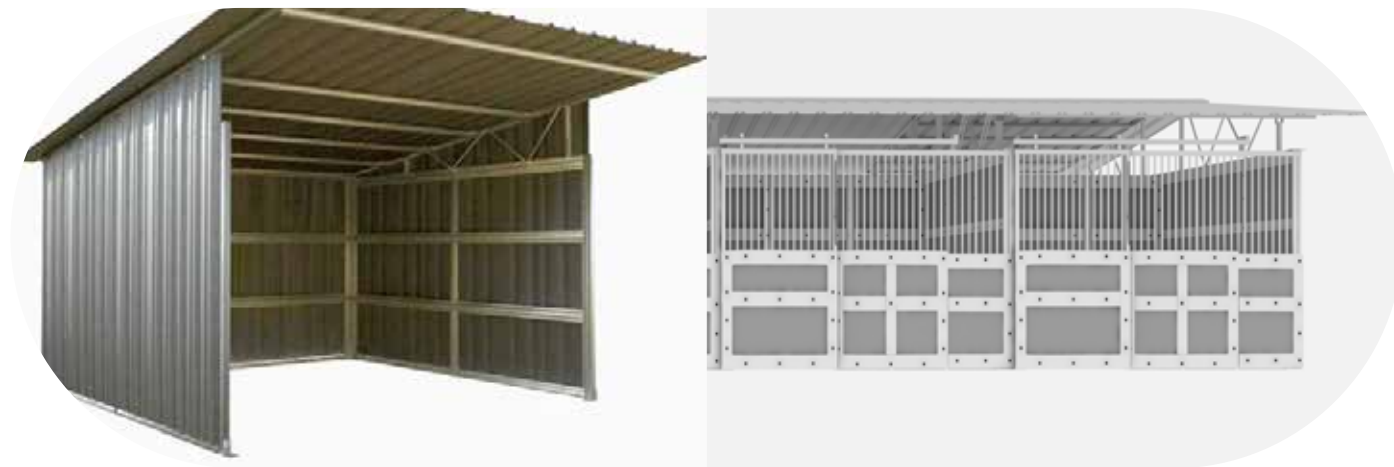

Full HDPE Portable Horse Stable Panel

The Full HDPE Portable Horse Stable Panel is designed to create fully enclosed HDPE board. It is usually used as side and back panels to isolate with others and to be a forage room or toolhouse.

Size: 3.6m x 2.2m Height, or 4.2m x 2.2m Height

Metal Frame: Hot dipped galvanised 50x50mm square tube, galvanising over 42um

HDPE Board: 10mm thick infill making stall durable, UV resistant

HDPE Board: 10mm thick infill making stall durable, UV resistant

Bolts and Nuts: HDG or SS304 Material

Connect way Pin: HDG finishes 40x40mm square metal

Process

Steel tubes cutting – welding panels – polishing the welding points – anti rust painting – silver spray painting – fix HDPE plate to stable panel and gate.

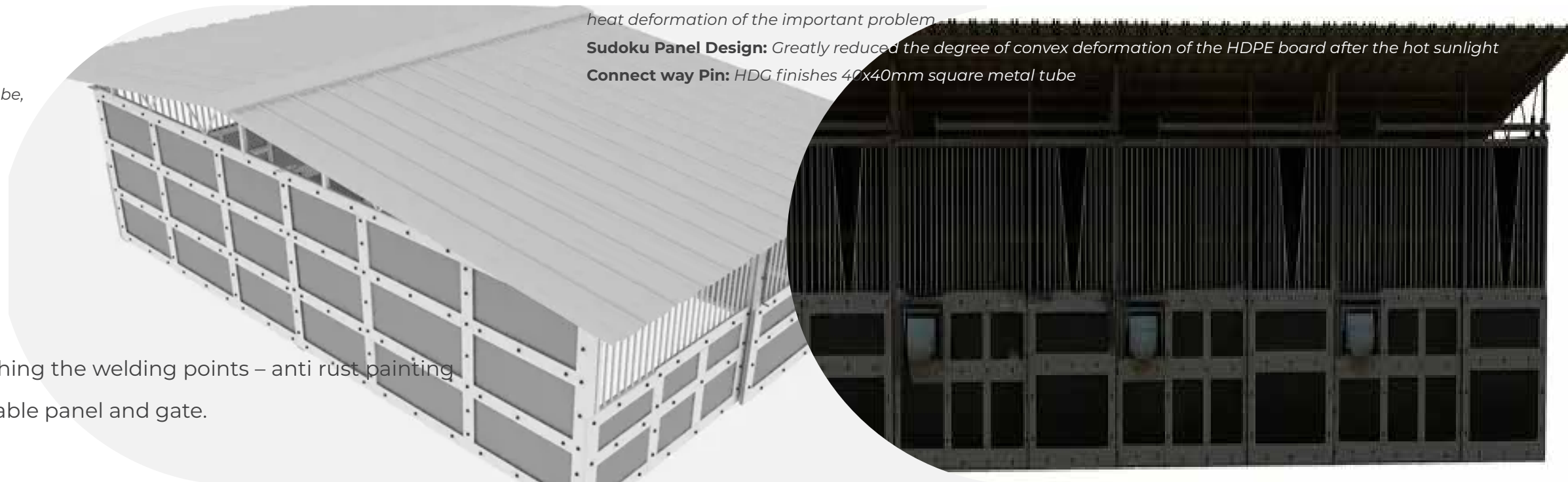

Quadruple Portable Horse Stable With Roof

Our Sudoku Quadruple Portable Horse Stable With Roof includes 4 front sides panels with gate + 4 back sides + 2 outside right/left panels + 3 Inner side panels+ grey roofs.

Size: 14.4m x 3.6m x 2.2m Height, or 16.8m x 4.2m x 2.2m Height (If with roofs, the max height is 2.9m at front and 2.5m at rear)

Metal Frame: Hot dipped galvanised 50x50mm square tube, galvanising over 42um

Infilled upper round gate pipe: HDG 20 x 1.2mm

HDPE Board: 10mm thick infill making stall durable, UV resistant

Roof: 0.4-0.8mm thick, power coated blue or grey color to resist rain and sun

Galvanised Splint: Arc design, fixed HDPE board and frame, will not hurt the horse, and solve the HDPE board heat deformation of the important problem

Sudoku Panel Design: Greatly reduced the degree of convex deformation of the HDPE board after the hot sunlight

Connect way Pin: HDG finishes 40x40mm square metal tube

Single Back-To-Back Portable Stables With Roof And Splint

Our Single Back-To-Back Portable Stables With Roof And Splint includes 2 front side panels with gates + 1 back sides + 2 outside right/left panels + grey roofs.

Size: 7.2m x 3.6m x 2.2m Height, or 8.4m x 4.2m x 2.2m Height (If with roofs, the max height is 2.9m at front and 2.5m at rear).

Metal Frame: Hot dipped galvanised 50x50mm square tube, galvanising over 42um

Infilled upper round gate pipe: HDG 20 x 1.2mm

HDPE Board: 10mm thick infill making stall durable, UV resistant

Roof: 0.4-0.8mm thick, power coated blue or grey color to resist rain and sun

Galvanised Splint: Arc design, fixed HDPE board and frame, will not hurt the horse, and solve the HDPE board heat deformation of the important problem

Sudoku Panel Design: Greatly reduced the degree of convex deformation of the HDPE board after the hot sunlight

Connect way Pin: HDG finishes 40x40mm square metal tube

Sudoku Back-To-Back Five Conjoined Horse Stables With Splint

Our Sudoku Back-To-Back Five Conjoined Horse Stable With Splint includes 10 front side panels with gate + 5 back side sharing + 4 outside right/left Panels + 8 Inner right/left Panels + grey roofs.

Size: 18m x 7.2m x 2.2m Height, or 21m x 8.4m x 2.2m Height (With roofs, the max height is 2.9m at front and 2.5m at rear).

Metal Frame: Hot dipped galvanised 50x50mm square tube, galvanising over 42um

Infilled upper round gate pipe: HDG 20 x 1.2mm

HDPE Board: 10mm thick infill making stall durable, UV resistant

Roof: 0.4-0.8mm thick, power coated blue or grey color to resist rain and sun

Galvanised Splint: Arc design, fixed HDPE board and frame, will not hurt the horse, and solve the HDPE board heat deformation of the important problem

Sudoku Panel Design: Greatly reduced the degree of convex deformation of the HDPE board after the hot sunlight

Connect way Pin: HDG finishes 40x40mm square metal tube

Sudoku Single Portable Horse Stable Without Splint

Our Sudoku Single Portable Horse Stable includes galvanised RHS frame, HDPE board fixed on the up and down frame, even the top colorbond roofs, swing/sliding gate for the front stable panel.

Size: 3.6m x 3.6m x 2.2m Height, or 4.2m x 4.2m x 2.2m Height (If with roofs, the max height is 2.9m at front and 2.5m at rear).

Metal Frame: Hot dipped galvanised 50x50mm square tube, galvanising over 42um

Infilled upper round gate pipe: HDG 20 x 1.2mm

HDPE Board: 10mm thick infill making stall durable, UV resistant

Roof: 0.4-0.8mm thick, power coated blue or grey color to resist rain and sun

Swivel Feeder: Aluminium material

Hinge and Switch: HDG material or SS304

Connect way Pin: HDG finishes 40x40mm square metal tube

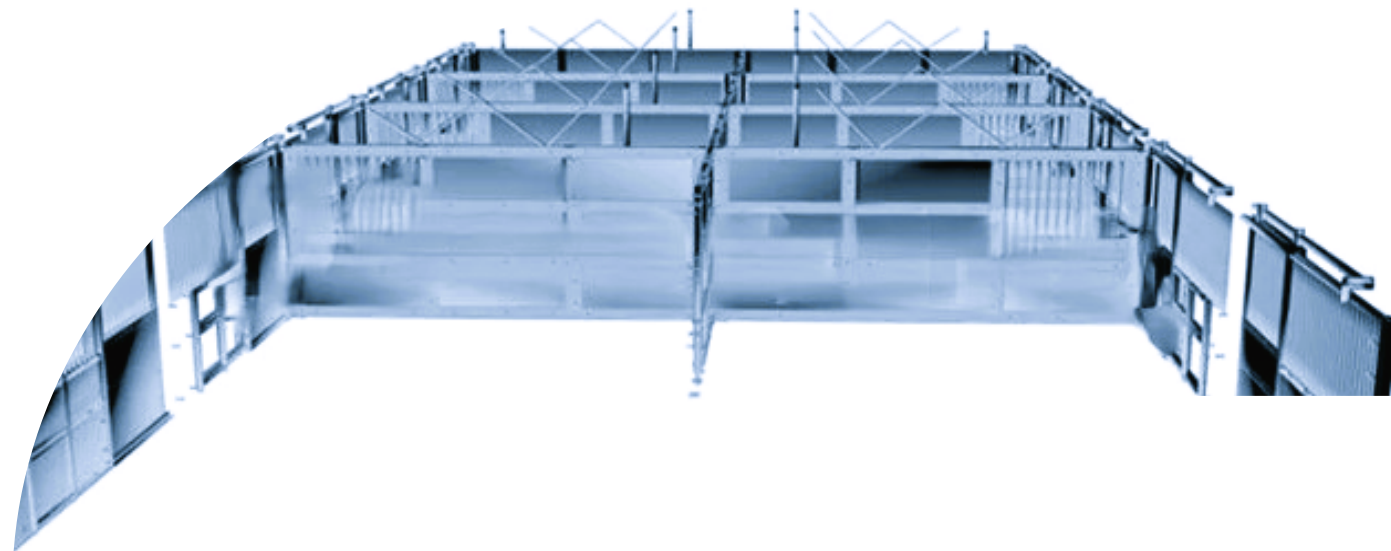

Sudoku Single Potable Horse Stable With Splint

Our Sudoku Single Potable Horse Stable With Splint includes 1 front side panels with gate + 1 back side + 2 outside right/left Panels + grey roofs + feeder.

Size: 3.6m x 3.6m x 2.2m Height, or 4.2m x 4.2m x 2.2m Height (With roofs, the max height is 2.9m at front and 2.5m at rear).

Metal Frame: Hot dipped galvanised 50x50mm square tube, galvanising over 42um

Infilled upper round gate pipe: HDG 20 x 1.2mm

HDPE Board: 10mm thick infill making stall durable, UV resistant

Roof: 0.4-0.8mm thick, power coated blue or grey color to resist rain and sun

Galvanised Splint: Arc design, fixed HDPE board and frame, will not hurt the horse, and solve the HDPE board heat deformation of the important problem

Sudoku Panel Design: Greatly reduced the degree of convex deformation of the HDPE board after the hot sunlight

Connect way Pin: HDG finishes 40x40mm square metal tube

Process

Steel tubes cutting – welding panels – polishing the welding points – anti rust painting – silver spray painting – fix HDPE plate to stable panel and gate.

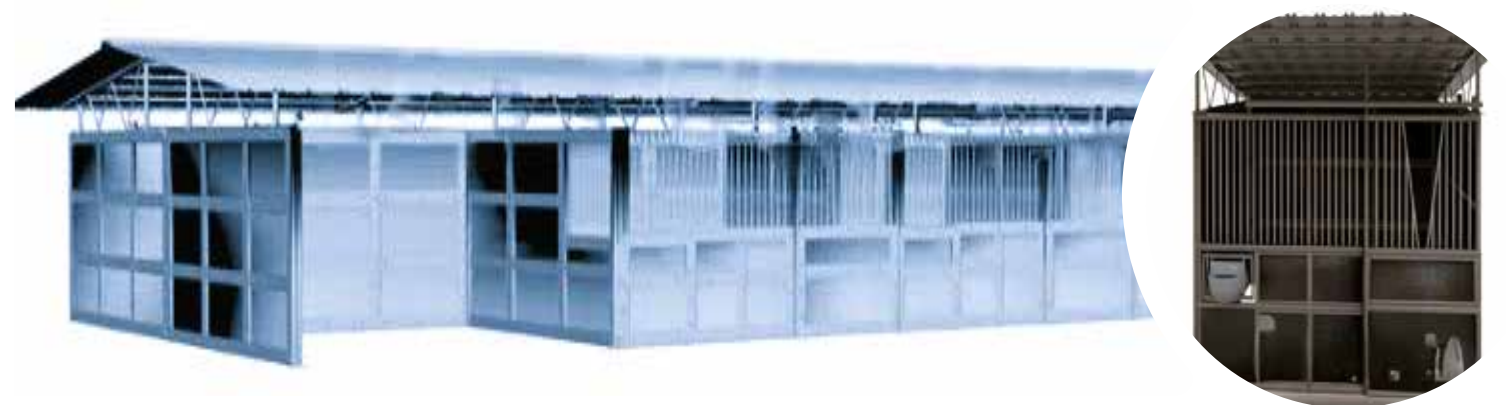

BLOG

Why Portable Horse Stable

Your favorite healthy horse should get the best care, relax, quiet moments, avoiding the cold weather, rains. A warm and safe home is so important to win the race for the trail, racing, breeding, or riding horses .

With a portable and pre-build designing, you can pasture and train your horse across the ranch from field to field.

Whether you own one loved horse or a collection of trail, racing, breeding, or riding horses, all of your animals need a place to be safe from the elements and time to exercise.

Horse owners know that portable horse stables are the first important to any ranch or large property.



Why Need Portable Horse Stable In Australia

. Horse racing is the third most-watched sport in Australia, portable horse stable make the thoroughbred horse get warm home and best rest, save its strength to win the Victoria Derby, Melbourne Cup, Srales Day, Golden Slipper Stakes, Caulfield Cup, and W S Cox Plate.

. Both Magic Millions and Inglis advocate the provision of strong, safe portable horse stables.

. More than 19,000 thoroughbred races are held in Australia every year, across all regions, each race horse should get the best protection.

. There are also many small and medium-sized racetracks in each state and country of Australia, with a total number of around 550. The horse owner, Bloodstack Consultant, Trainer, Trader/Pinhooker, and Bloodstack Consultant would like their horse get the best feed.

. Sydney and Melbourne are the two centres of racing in Australia.

The portable horse stables are the best quarantine grounds

Off the track Thoroughbreds now have another new place to stay and be retrained Our portable horse stables can be used in both indoor and outdoor with all kinds of size. If outdoor, it should only add another colorbond roofs to anti-rain and sunshine. The portable horse stable panels can be made of upper mesh or round pipe as your request. It can be HDPE board, plywood, colorbond or hardwood to be fixed with bolts.

We have a full accessory suit for our portable horse stable panels including spinning feeder doors, chain to lock the door, with matching tie up areas and wash bays.

Easy to install, anti-corrosion, long service lifespan.



Frank Zhang

Hi, I'm Frank Zhang, the funder of dbstable.com, I've been running a factory in China that makes portable horse stable for 10 years now, and the purpose of this article is to share with you the knowledge related to portable horse stable from a Chinese supplier's perspective.

FEEDBACK

Our Happy Clients From Australia & New Zealand !



The legends DB Stable showed up right, not only delivered 4 gorgeous stables, but they helped us how to set them up! These stables are not only beautiful, but super sturdy and built to last (great for thoroughbreds that don't know what "stand patiently" means).

Tony



Jeson Foxx



Thanks Frank for your professionalism. It was an exciting morning installing our new portable horse stables. Highly recommend Portable Horse Stables. I'm sure the horses will Love their new accommodation.

Purchasing Steps

Customers visit the website first, and then send us an inquiry on the website by filling in the form. our salesman will quote the price to the purchaser after getting the purchase information. after the two sides confirm all the transaction details, we will send samples to the users. after the user is satisfied with the sample, he will give us the final order.

After the factory has finished producing the goods, it will be sent to the customer's country by sea.

Platform Advantages

We have been launching the B2B platform before, but the effect has declined seriously in recent years, so we need to do a website to do marketing and sell goods.

Although the price of our competitors' products is very low, but the quality is very poor, overseas procurement is tired of this kind of low-quality products.

